

Lura[®]

- 1200 Watt
- Stainless Steel Blades
- 5 different speed options
- Slicer and Grater Function
- 1.75 L Grating and Slicing Bowl
- Chopping Function with Double Blades
- Stainless Steel Beaters
- Detachable Gear Box Lock Mechanism
- Easy-to-Grip Handle
- Easytouch Buttons
- Ergonomic Design
- 700 ml Measuring Cup
- Washable Accessories
- Extra-Durable Chopping Bowl

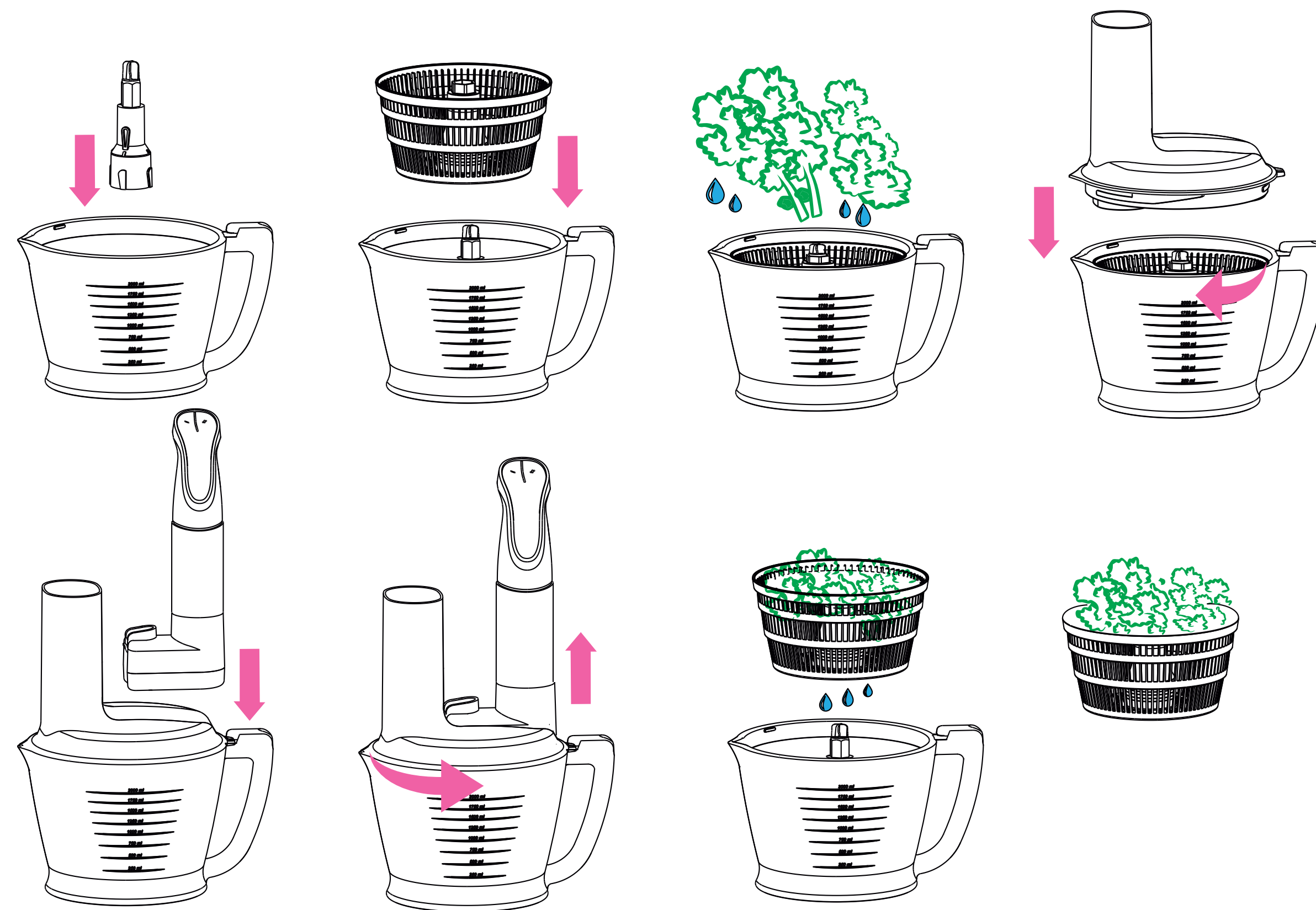

Lura blender allows you to easily perform your whisking, chopping and shredding tasks, thanks to its ergonomic design and technical features. With its stainless steel blades, double beater unit and extra durable bowl, many recipes can be prepared in seconds.



Lura Hand Blender Set stands out with its practical details. The 1200-watt motor of the model with five-stage speed adjustment performs the mixing function in the shortest time in an effective way. Thanks stainless steel blender apparatus, it can easily crush and grind fruit and vegetable solid food materials without splashing around. Thanks to the double beater and double blade chopper container, both the product performance and the pleasure of spending time in the kitchen are doubled.

Also , thanks to the greenery drying apparatus, the washed greens placed in the chamber can be purified from their water in seconds.

After the researches in R&D department, all parts of the blender are designed so that they can be assembled -reassembled very quickly and with a minimum error rate. As a result of those economical designs, the cost of the production has decreased, therefore more products were produced.

In the development phase of Lura, hundreds of prototypes for chopping system has been made and tested in the laboratories. As a result of those researches, the high efficient anti splash feature, which allows the materials blend homogeniously in a better way without splashing , has been developed. After the researches in R&D department, all parts of the blender are designed so that they can be assembled -reassembled very quickly and with a minimum error rate





Lura Hand Blender Set stands out with its practical details. Easy-to-grip handle and "Easytouch" buttons make your work easier in the kitchen with dishwasher-safe accessories. There is five stage speed adjustment button built in the hand blender.

We have to ensure that on off and speed adjustment buttons placed on the most ergonomic spot that should be very easily operated but on the other hand it should not be operated by accident. It was a big challenge to meet the ergonomic needs with the safety standards. The final result is very satisfying both for the ergonomic and the aesthetic aspect.

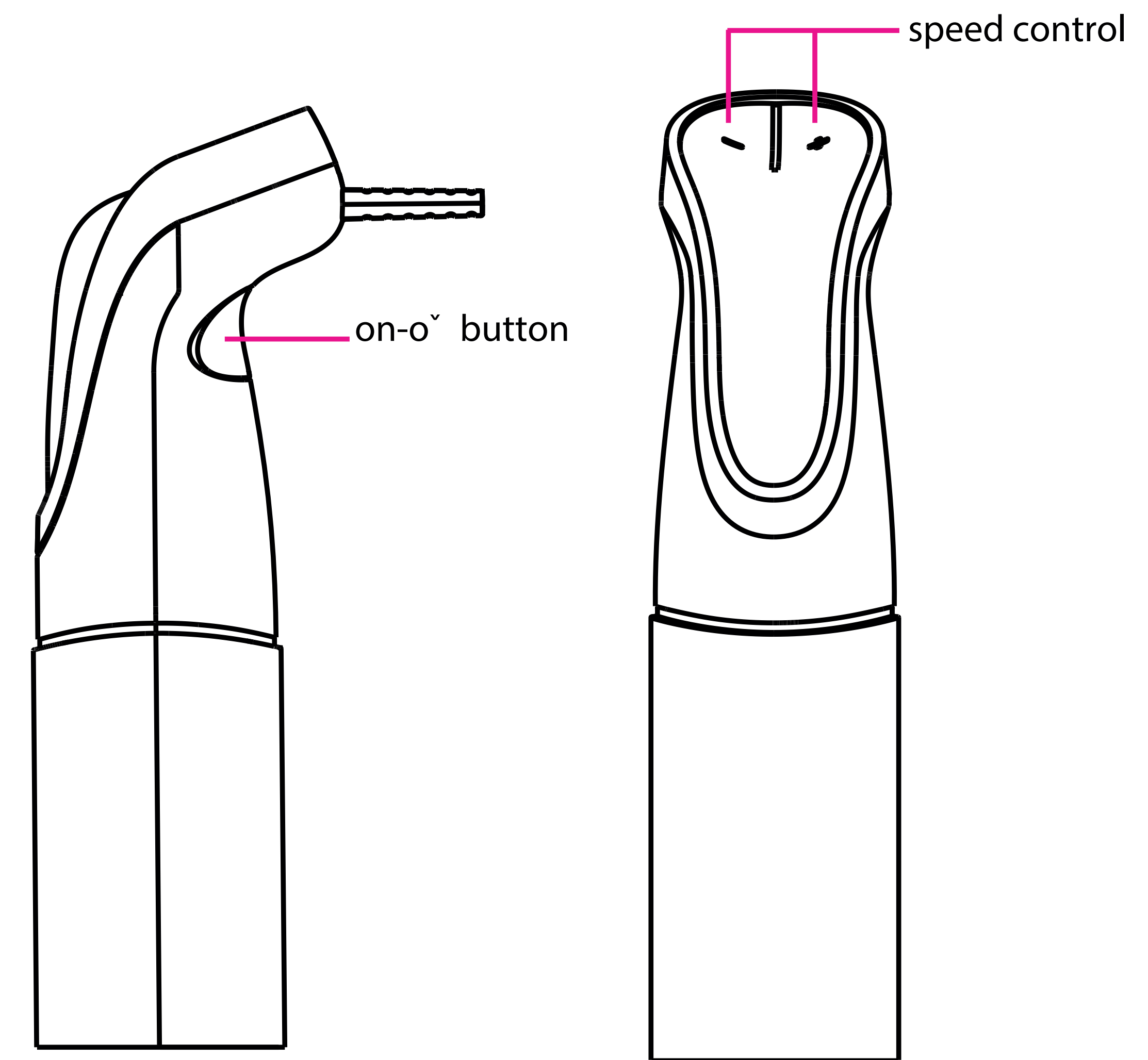



In traditional blender designs, the construction of the gearbox inside the chamber cover complicates the construction of the chamber cover and makes it impossible to clean the chamber cover easily under water.

As a result of washing the lid having an integrated the reduction gear mechanism, water may leak from the inter-cavity spaces to reduction gear mechanism which causes rusting of the parts inside, reducing their lubricity and deterioration of the gears. In some complex systems, bi-directional couplings that is arranged on the lid having a plurality of parts are used. In such systems, it is not easy to clean the food residues that escaped between the couplings.

Moreover, even if two different couplings are used, it is possible for the reduction gear mechanism to be placed directly on the drive shaft without the lid and to operate the food processor, which poses a great danger for the user.

Thanks to the new patented gear box feature all of those problems have been solved.

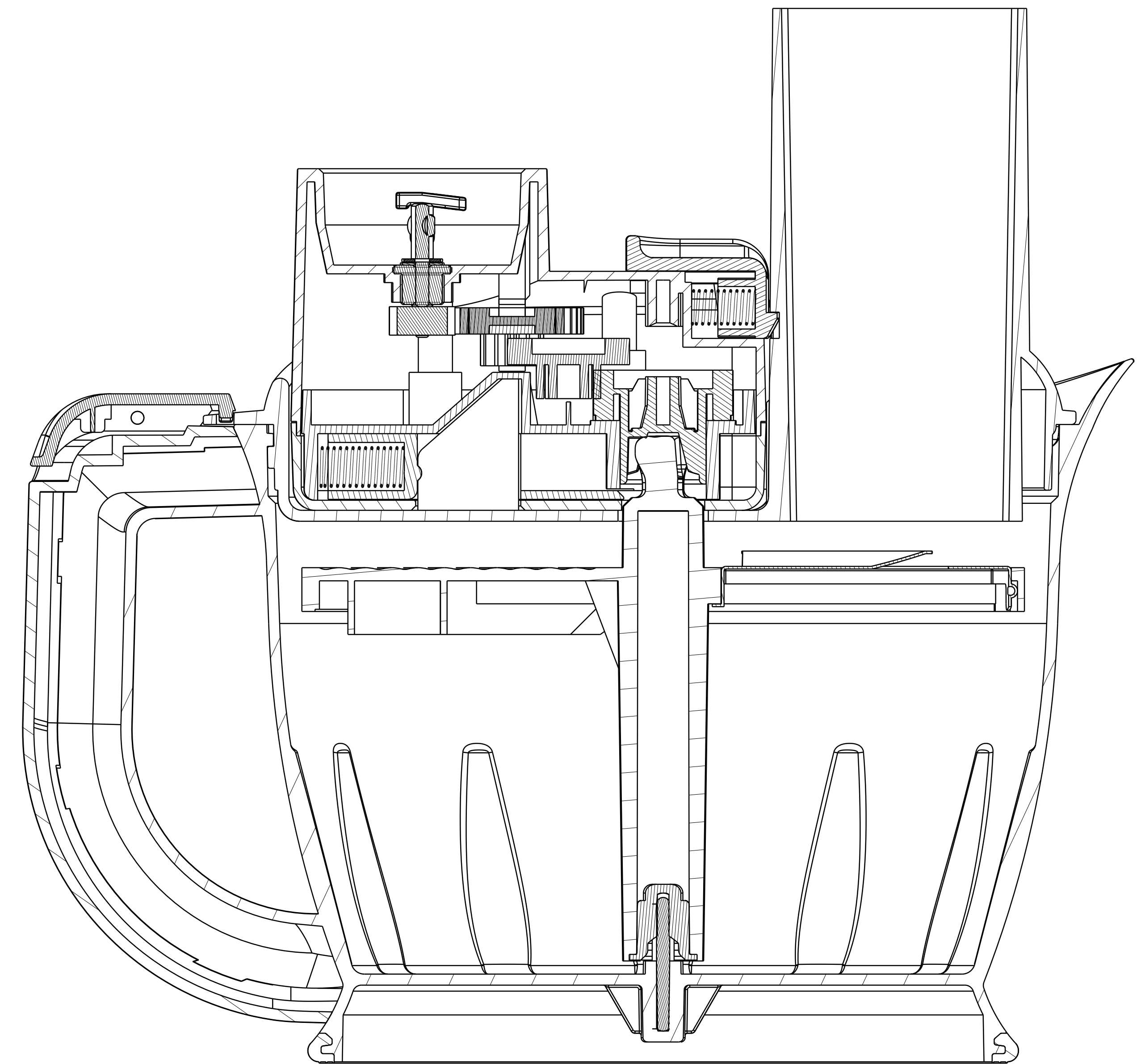

Thanks to patented gear box design on Lura hand blender , gearbox can be separated from lid easily with one click, and the lid can be washed through running water or even in dishwasher safely



Since it is a system that closes the coupling connections when the gear box is removed from the lid, it will not be possible to use the drive unit without the lid on the container. Thus, the system meets the Safety Requirements.

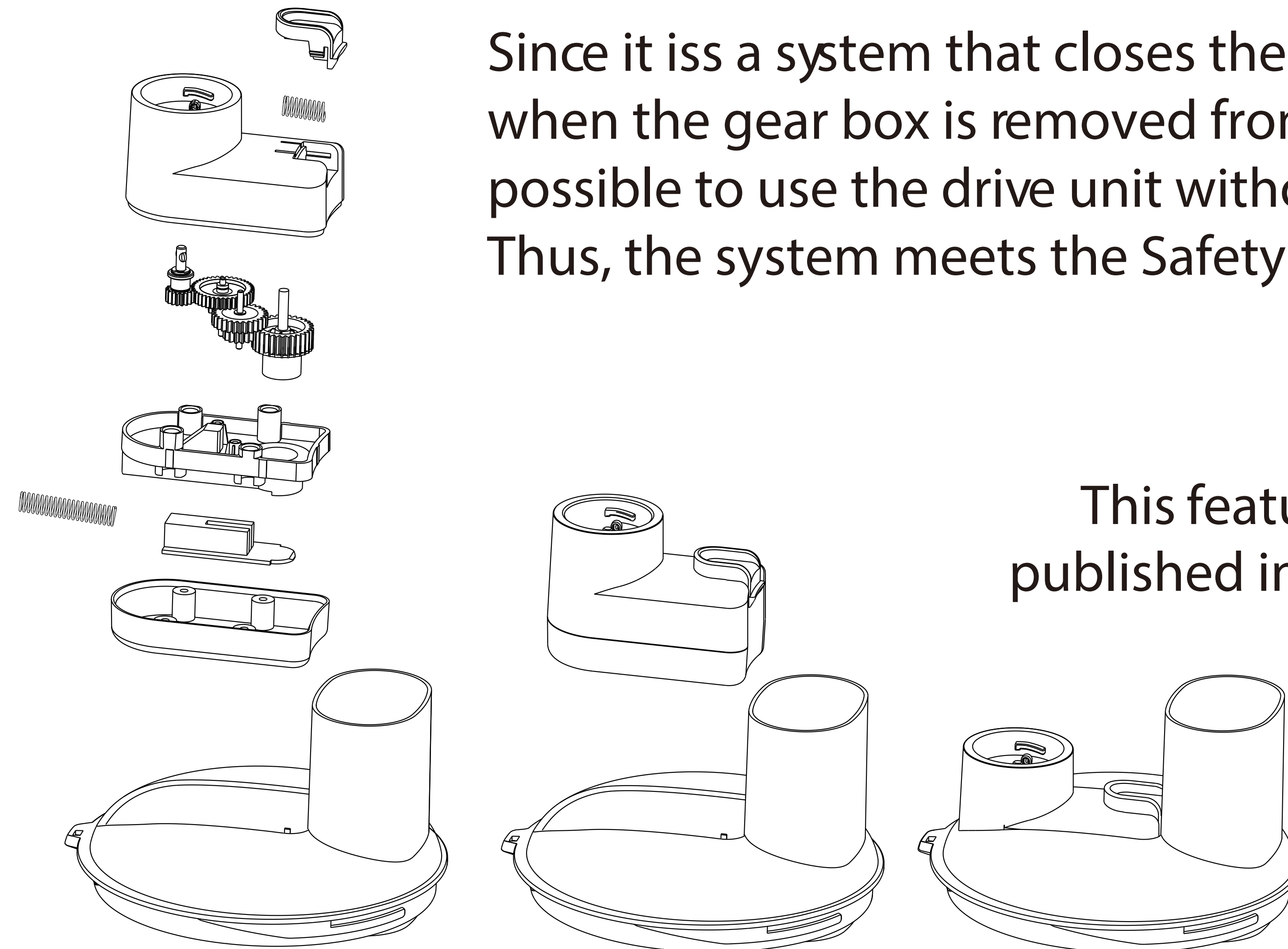

This feature has been patented and published in European Patent Bulletin (EP 19172039.0)



The main bowl used in chopper and grating operations has a durable feeling and glass like effect at the same time. The wall thickness reaches up to 8 mm on the edges that gives more durability to the product and glassy feeling to the user.

Also thanks to the pouring spout, the food that is shredded or grated in the bowl can be easily emptied after the operation is completed.



The hot foil application gives the product high end look at affordable cost. In most of the high end products, sheet metals are used in the main body of the blender to achieve a high end look but it has no plus to the end user. The metal covering on the main body doubles the cost. We used hot foiling instead of sheet metal, which is much more cost effective and still has the same shiny look and strong feel.

