

PROJECT: TYPE: CAT. #: SV - - - - -

## PROFILE

LIGHT SOURCE	HIGH PERFORMANCE CV LED'S
OUTPUT	12.0W/FT
PERFORMANCE	105 LM/W
INDIRECT DISTRIBUTION	BATWING
CCT	2700K - 4000K
CRI	82 CRI
VOLTAGE	UNIVERSAL 120-277V
POWER	REMOTE POWER SUPPLY
CONTROL	0-10V, DMX, LUTRON
SIZES	24"-96", CONTINUOUS
HOUSING	EXTRUDED ALUMINUM
FINISH	TEXTURED WHITE, BLACK, GREY, OR CC
WARRANTY	5-YEAR LIMITED
CERTIFICATION	ETL AND cETL FOR DRY LOCATION



FIXTURE SHOWN:  
SV-I-MO-40-ACA-48-DIM-TW-TW

## PROFILE

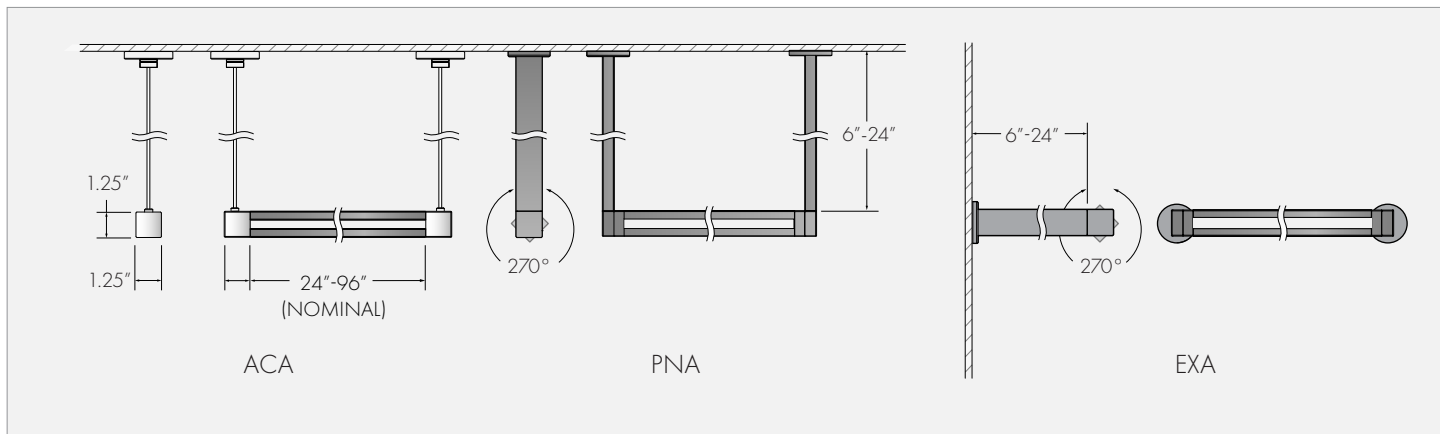

## DISTRIBUTION

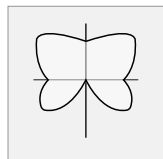

BUTTERFLY

## OPTIONS



ANODIZED END CAPS  
(SA)

## FINISHES



TEXTURED  
WHITE

TEXTURED  
BLACK

TEXTURED  
GREY

CUSTOM  
COLOR

PROJECT: TYPE: CAT. #: SV - I - - - - - - - - -

Separate options with dashes

SV	I			-						
1	2	3	4	5	6	7	8	9		10

1	<b>FIXTURE</b>		
	STRUCTURE SPLIT	SP	
2	<b>LIGHT DIRECTION</b>		
	INDIRECT	I	
3	<b>OUTPUT</b>		
	LOW	LO	
	4.0 W/FT Direct   4.0 W/FT Indirect batwing		
	MEDIUM	MO	
	8.0 W/FT Direct   8.0 W/FT Indirect batwing		
	HIGH	HO	
	12.0 W/FT Direct   12.0 W/FT Indirect batwing		
	2 drivers per fixture are provided.		
4	<b>CCT</b>		
	2700K	27	
	3000K	30	
	3500K	35	
	4000K	40	
5	<b>MOUNTING</b>		
	SUSPENSION ARCH.	ACA-X	
	X = cable length specify to 96"		
	EXTENDED ARM ARCH.	EXA-X	
	X = arm length up to 24"		
	PENDANT ARCH.	PNA-X	
	X = pendant length specify to 96"		
6	<b>LENGTH</b>		
	48"	48	
	72"	72	
	96"	96	
	CONTINUOUS	X	
	Specify run length in twelve inch increments		
	Contact factory as drawings are required		
	See options		
	Continuous run option must be included		
7	<b>CONTROL</b>		
	0-10V DIMMING	DIM	
	DMX DIMMING	DMX	
	DMX Programming Kit is required. See below.		
	LUTRON	L3DOE	
	L3DOE - Hi-lume premiere 0.1% EcoSystem 24V constant voltage LED driver with soft-on, fade to black dimming technology		
	Not available with ISJ and HCISJ		
	Dimming control system to be supplied by others		
8	<b>LUMINAIRE FINISH</b>		
	TEXTURED WHITE	TW	
	TEXTURED BLACK	TBL	
	TEXTURED GREY	TG	
	CUSTOM COLOR	CC	
	Contact factory for custom color - additional charges will apply		
9	<b>CANOPY FINISH</b>		
	TEXTURED WHITE	TW	
	TEXTURED BLACK	TBL	
	TEXTURED GREY	TG	
	CUSTOM COLOR	CC	
	Contact factory for custom color - additional charges will apply		
10	<b>OPTIONS</b>		
	HIGH CRI +90	HCRI	
	ANODIZED END CAPS	SA	
	Silver anodized end caps and continuous hubs		
	JBOX MOUNTING KIT	JBK	
	Cover plate to allow mounting to a 4.0 j-box		
	Cover plate finish is the same as the canopy		
	JBOX MOUNTING		
	INTEGRAL PWR. CANOPY	ISJ	
	Surface mounted canopy with integral power supply		
	SURFACE MOUNTING		
	INTEGRAL PWR. CANOPY	HCISJ	
	Surface mounted canopy with integral power supply		
	For non-accessible ceilings		
	RECESSED MOUNTING KIT	RMK	
	In-ceiling micro-enclosure for gypsum, drywall, and retrofit applications		
	PLENUM 120V PWR SUPPLY	PL120	
	Plenum power supply available with j-box only		
	All plenum cabling provided by others		
	PLENUM 277V PWR SUPPLY	PL277	
	Plenum power supply available with j-box only		
	All plenum cabling provided by others		
	CONTINUOUS RUN	CR	

## OPTIONAL CONTROLS

[Go to DMX guide >](#)

DMX DISTRIBUTION & PROGRAMMING KIT - REQUIRED FOR DMX DIMMING

DMX/RDM DISTRIBUTION KIT (4 OUTPUTS) - IP67 CDS-RDM

DMX/RDM Distribution Kit consists of four outputs

Each output is limited to (1) run per output - up to 32 fixtures max

Four terminators are included for end of line termination

PROJECT:

TYPE:

CAT. #: SV - I - - - - -

**FIXTURE DIMENSIONS - PNA/EXA MOUNTING**

DIMENSION	24"	36"	48"	72"	94"
DIM A	24.30"	35.80"	48.30"	71.80"	94.30"
DIM B	23.00"	33.50"	47.00"	70.50"	93.00"
DIM C	25.43"	36.93"	49.43"	72.93"	95.43"

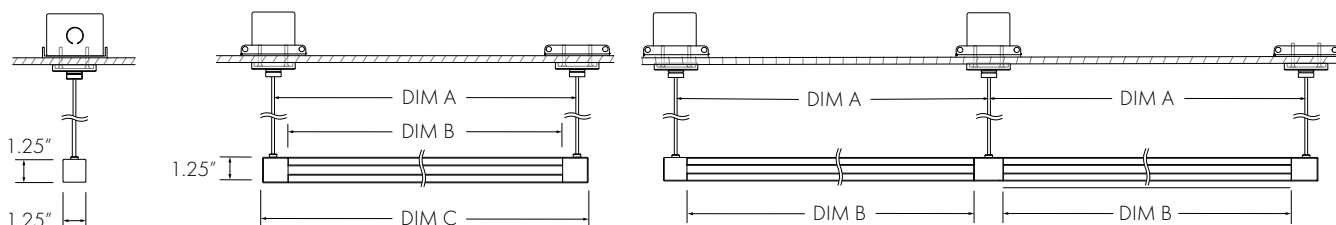
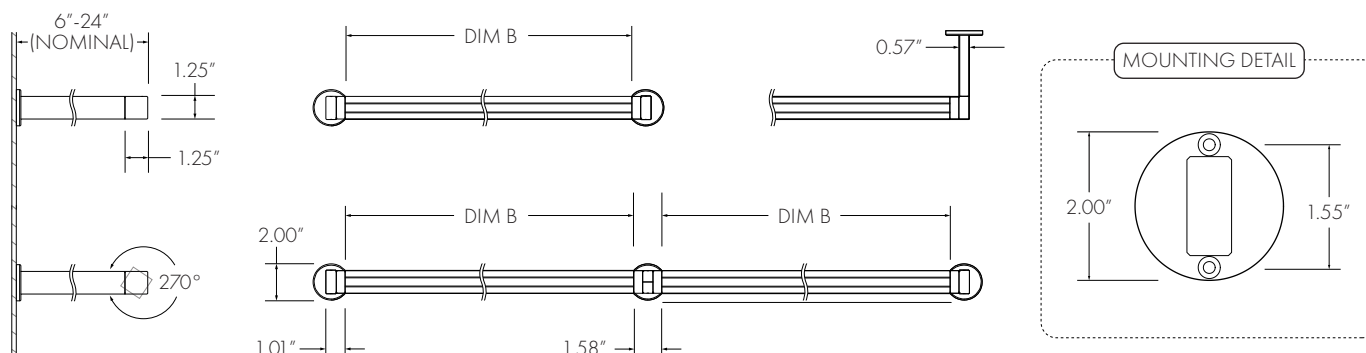
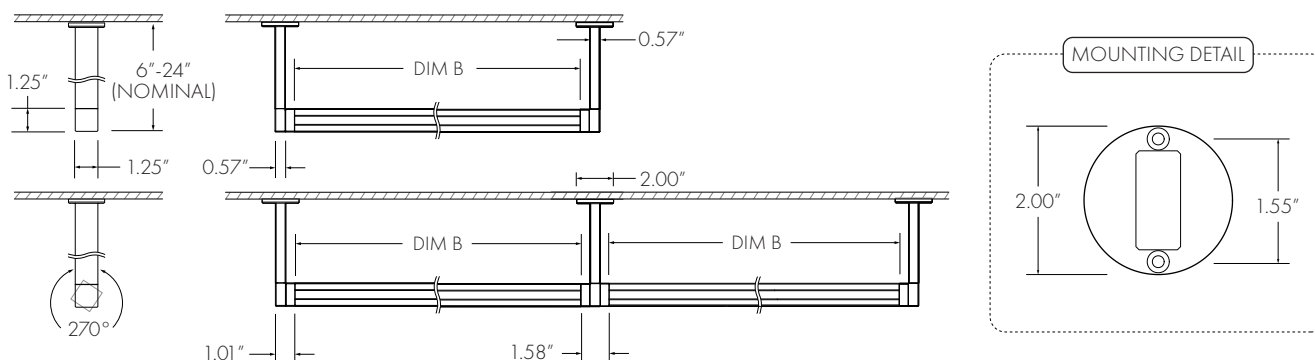
**SUSPENSION ARCHITECTURAL (ACA)**

**EXTENDED ARM ARCHITECTURAL (EXA)**

**PENDANT ARCHITECTURAL (PNA)**

PROJECT:

TYPE:

CAT. #: SV - I - - - - -

## MOUNTING OPTION DIMENSIONS

### ARCHITECTURAL MOUNTING (PROVIDED AS STANDARD)

for accessible ceilings | remote power

- Plenum rated micro-enclosure
- 3 x 0.88" knockouts for 0.50" conduit
- 2.00" canopy at power feed location (not provided with surface mount)
- 2.00" canopy at non-power feed location (not provided with surface mount)

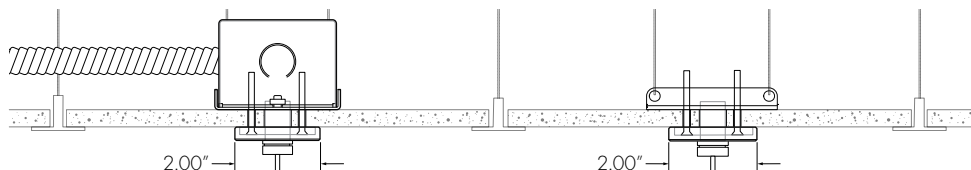

### JBOX MOUNTING KIT (JBK)

for accessible ceilings | remote power

- Two-part 4.50" jbox cover plate with concealed fasteners
- 2.00" canopy at power feed location
- 2.00" canopy at non-power feed location. Contact factory for additional non-power feed canopy options.

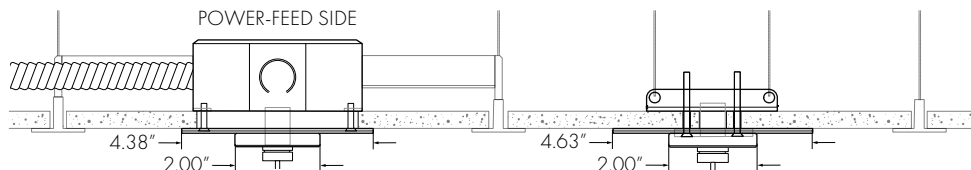

### JBOX MOUNTING INTEGRAL POWER CANOPY (ISJ)

for accessible ceilings | integral power

- Surface mounted canopy with integral 90.0 W driver with dimming
- Includes 2-96.0 W drivers
- 2.00" canopy at non-power feed location. Contact factory for additional non-power feed canopy options.

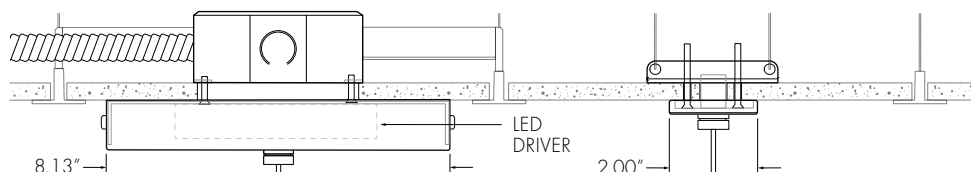

### SURFACE MOUNTING INTEGRAL POWER CANOPY (HCISJ)

for non-accessible ceilings | integral power

- Surface mounted canopy with integrated 90.0 W driver
- Includes 2-96.0 W drivers
- 0.50" conduit ready
- 2.00" canopy at non-power feed location. Contact factory for additional non-power feed canopy options.

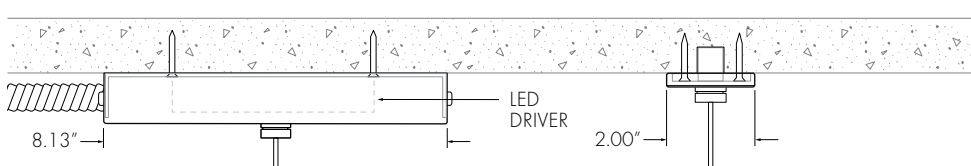

### RECESSED MOUNTING KIT (RMK)

for semi-accessible ceilings (drywall) | remote power

- 5.00" x 1.47" x 1.47" in-ceiling wiring enclosure for drywall and retrofit applications
- Two-part 3.50" jbox cover plate with concealed fasteners
- 0.50" conduit ready
- 2.00" canopy at non-power feed location. Contact factory for additional non-power feed canopy options.

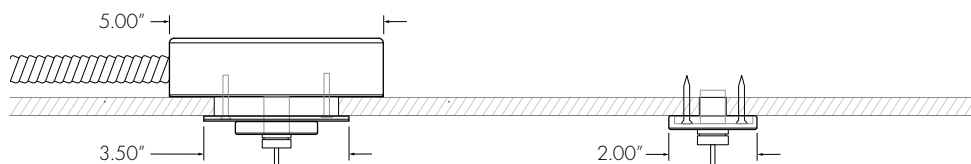

### RECESSED INTEGRAL POWER MOUNTING KIT (RIK)

for semi-accessible ceilings (drywall) | integral power

- 12.00" x 2.37" x 1.58" in-ceiling wiring enclosure with integrated 96.0 W dimming driver for drywall and retrofit applications
- Two-part 3.50" jbox cover plate with concealed fasteners
- 0.50" conduit ready
- 2.00" canopy at non-power feed location. Contact factory for additional non-power feed canopy options.

