

UNIVERSUM

c o l l e c t i o n





**“That’s one
small step
for
[a] man,
one
giant leap
for
mankind”**

Since ancient times, people have been looking at the stars, trying to understand how the universe works. From a huge number of myths and legends to Einstein's theory of relativity. It took humanity more than 2000 years to move from the flat-Earth theory and geocentric model to a modern idea of the Universe structure, send a man into space, land on the Moon and begin to conquest Mars.

The Hvilina's UNIVERSUM collection was inspired by the romanticism of space travel and is dedicated to the perseverance and incredible ingenuity of man in search of the truth. This collection is our attempt to reflect the shift from ancient astronomers and philosophers to modern achievements of astronautics and astronomy, to demonstrate how much the understanding of the world structure has changed.

Mechanical Blue

The watch is equipped with two time display rings.

The collection is available in three colors: BLACK, GRAY, and BLUE.
The case diameter is 42 mm.

The watch has a mechanical Japanese Seiko automatic movement. The case is made of stainless steel with the sapphire glass.



Grey



Blue



Black



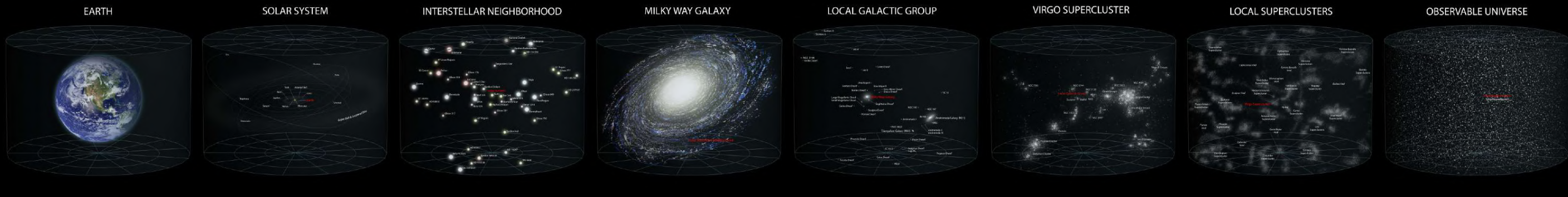

Modern chart

To implement the concept in the watch design, we came up with the idea to use celestial charts as symbols

On the left part of the dial, there is an ancient celestial chart while a modern one is displayed on the right part. Both charts point out the structure of the solar system and reflect the vision of both ancient and modern astronomers thus demonstrating how much we have advanced. The theory of the geocentric system of the world was taken as the ancients' idea of the Universe.



Illustration of the geocentric system of the world from Harmonia Macrocosmica by Andreas (1708)

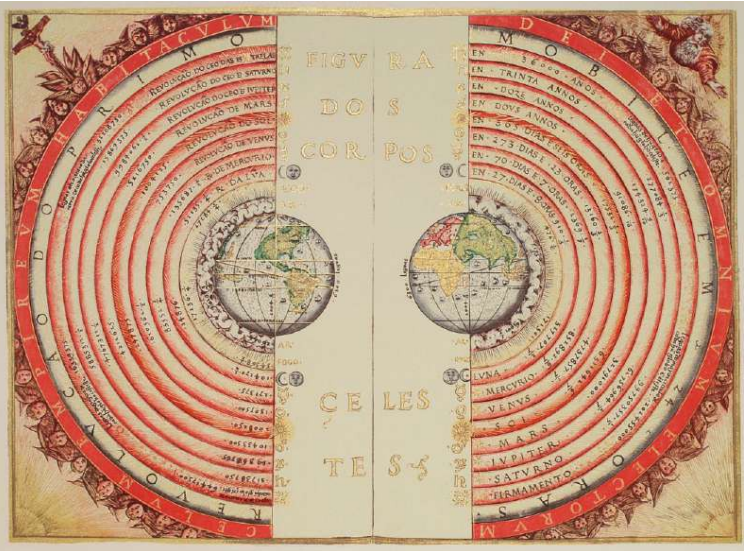

"Figure of the Heavenly Bodies" is an illustration of the geocentric system of the world made by the Portuguese cartographer Bartolomeu Velho in 1568.

This theory was widely spread in antiquity and stated that the planet Earth was located in the centre of the Universe; the objects of the solar system, including the Sun, rotated around it; and behind the solar system, there was a sphere of fixed stars which contained all the other luminaries that a person could observe in the starry sky. This theory served as the basis of ancient and medieval astronomy and cosmology.

One of the earliest extant images of the celestial chart representing the geocentric system of the world is a manuscript dated to the IX century.

It depicts Earth in the centre as well as the objects of the Solar System known at that time (note that the Sun is located in the middle, between Venus and Mars).

Commentary on the Dream of Scipio by Macrobius, IX century manuscript





The left part of the dial displays the stylization of this chart and symbolizes the idea of the cosmos at that time.

The right part of the dial displays the same celestial bodies, but in the correct sequence in the Solar System, thereby symbolizing today's understanding of the structure of the Universe as a whole.



All inscriptions on the left side of the dial are made in Latin in accordance with the ancient source. In contrast, on the right side, English is used, which is the modern incarnation of Latin. Thus, a symbolic transition from one era to another was displayed.

The design of the hands is made in a planetary theme, which corresponds to the general style of the concept.

Engraving on the winder

Genuine leather strap



24 hour guide on how to determine the time using a watch

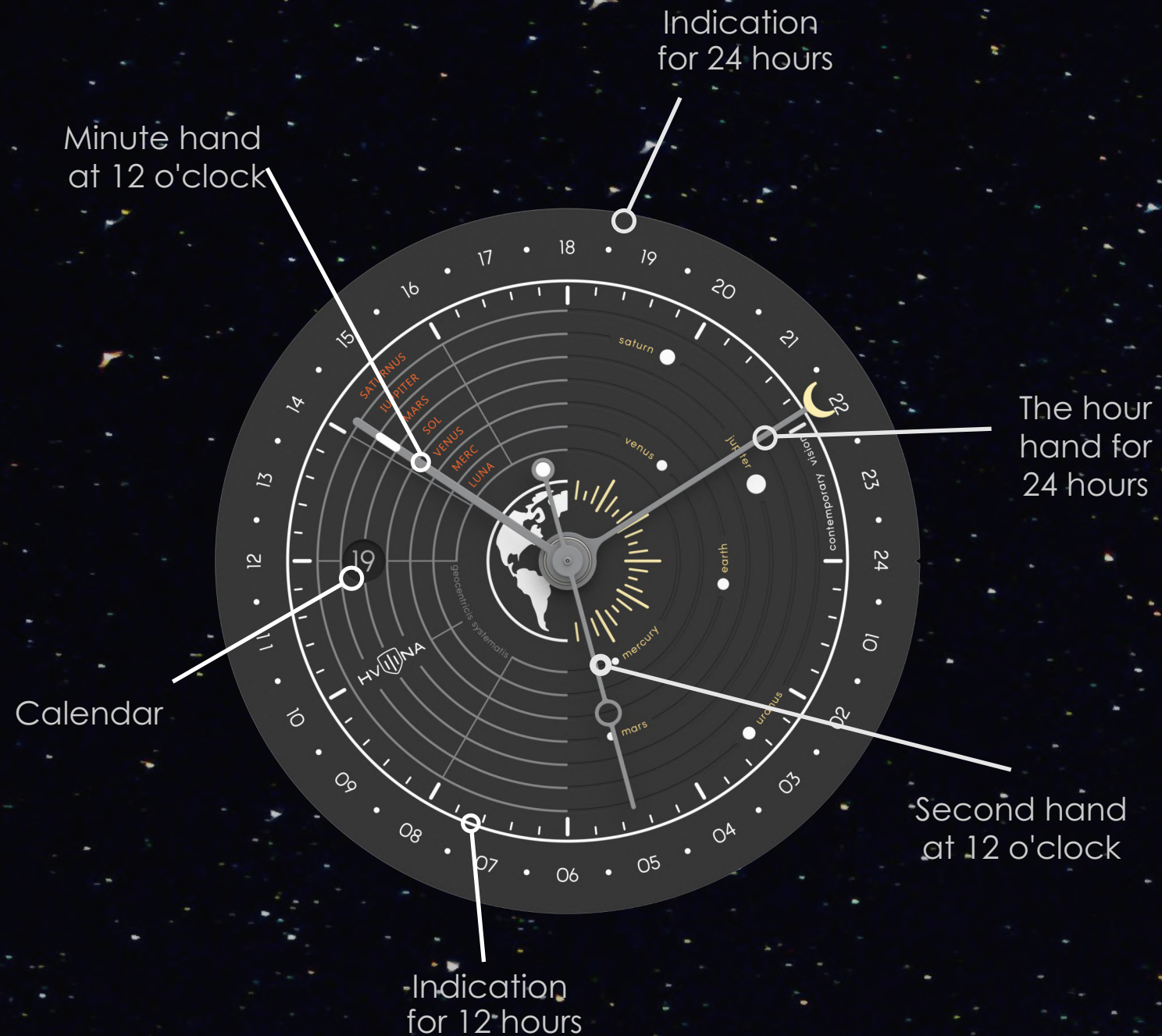



The watch is equipped with three hands and two-time display rings — internal and external. The external ring comes with a full hour hand rotation in 24 hrs while the internal, or classic one, is equipped with a rotation of the minute and second hands in 12 hrs. The watches are also equipped with a calendar, which is located on the left side of the dial.

- mechanism – Seiko NH34A movement (24 stones)
- 24-hour dial, automatic winding, calendar;
- case material – stainless steel case;
- sapphire crystal with anti-glare;
- genuine leather strap;
- water resistant (3 ATM);
- case diameter – 42 mm;
- thickness – 12.5 mm;
- sapphire crystal on the reverse side;
- strap width – 22 mm;
- limited edition – 365 pcs. each mode.

- mechanism – Seiko NH34A movement (24 stones)
- 24-hour dial, automatic winding, calendar;
- case material – stainless steel case;
- sapphire crystal with anti-glare;
- genuine leather strap;
- water resistant (3 ATM);
- case diameter – 42 mm;
- thickness – 12.5 mm;
- sapphire crystal on the reverse side;
- strap width – 22 mm;
- limited edition – 365 pcs. each mode.

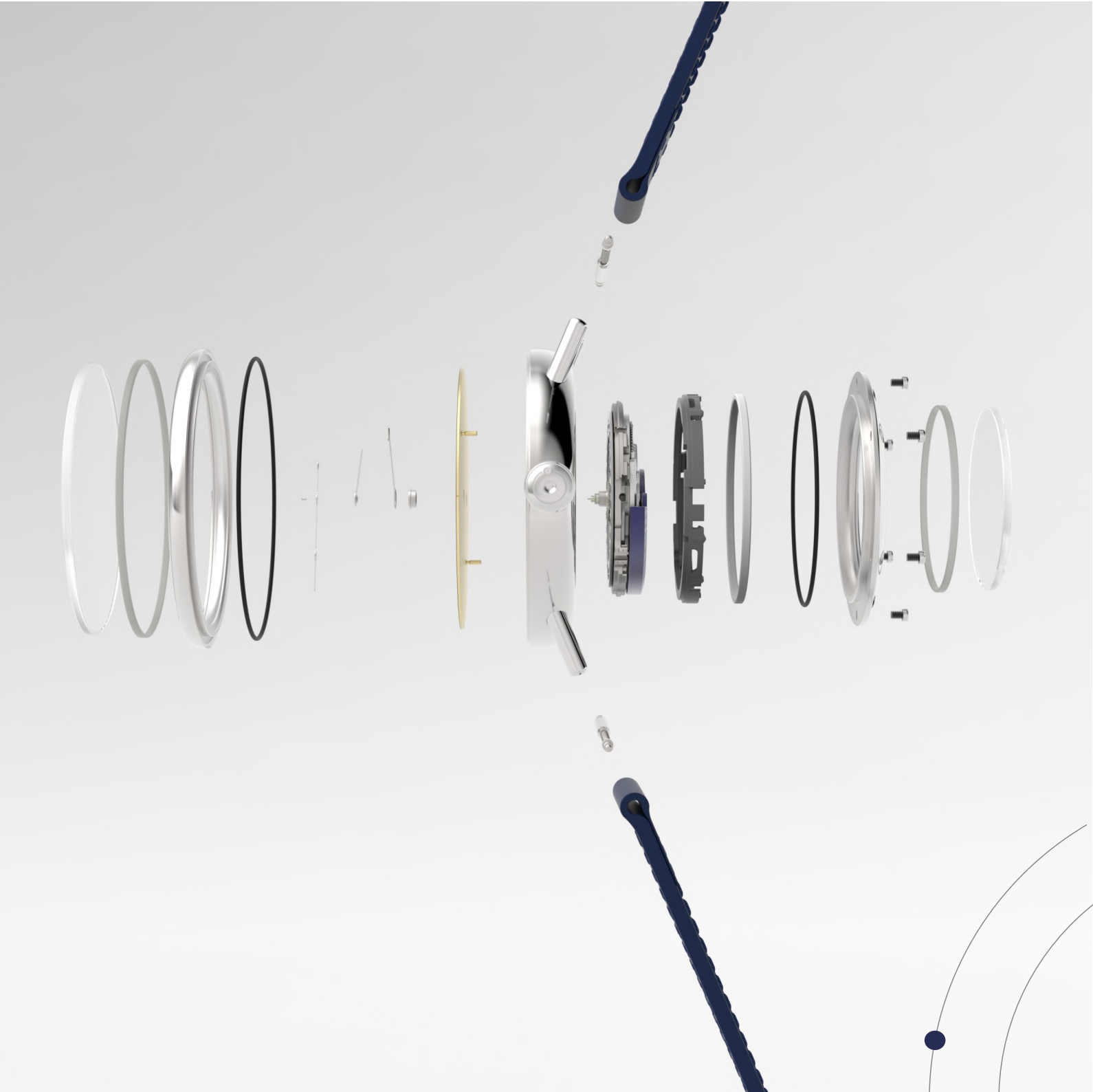



The back cover is transparent and made of sapphire crystal. The rotor of the movement is engraved with the name of the collection. On the circle there is an engraving with characteristics and number from the limited collection. The watches are limited: each model is manufactured in the amount of 365 units.

UNI VER SUM

limited edition
blue

