

# Project Background

E-learning plays an important role in the education system, with more and more people using it for self-directed learning to address the imbalance in educational resources. However, challenges include the high cost of paid resources, difficulty finding suitable free materials, and a lack of comprehensive curricula and guidance.

If we could make self-directed E-learning more efficient, effective, and affordable, it would significantly enhance the learning experience for people across diverse regions worldwide, promoting educational equality and lifelong learning.

**WisdomPlan**





# Project Overview

To address these challenges, we introduced an innovative solution—WisdomPlan. By leveraging AI, users can generate personalized learning paths tailored to each learner's background with just one click and receive support from an AI tutor throughout their journey.

WisdomPlan bridges the gap between abundant open educational resources and personalized learning. It uses AI for plan creation, resource curation, quiz generation, and tutoring, promoting lifelong learning and advancing educational equality.

WisdomPlan

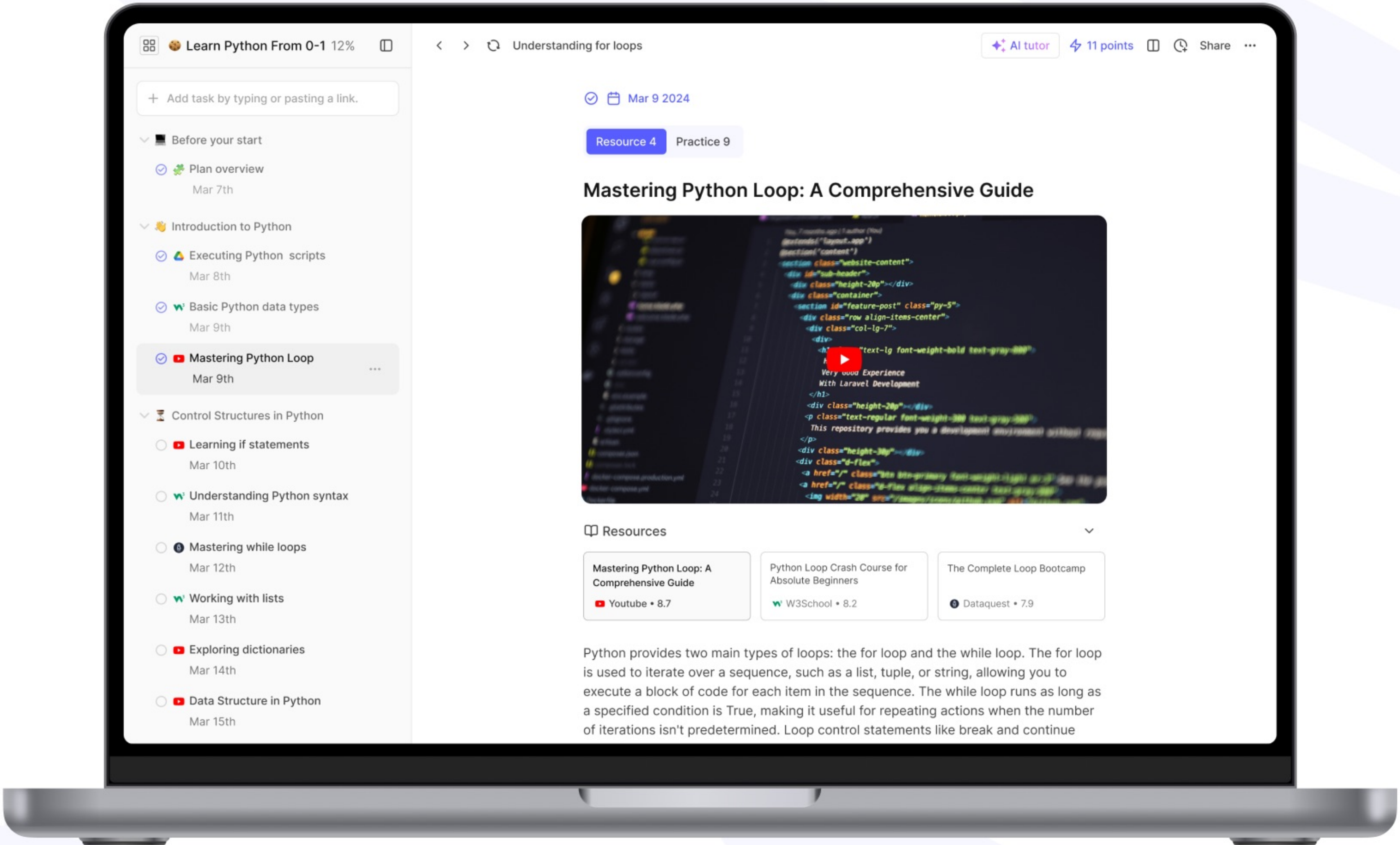



# Personalization

## Create Personalized Learning Plan

Users can create their own personalized learning plans based on their goals, educational background, relevant skills, and planned study time.

WisdomPlan uses AI to automatically search through vast amounts of free resources available on the internet, based on the user's data. It then evaluates and selects the most suitable resources for the user, combining them to form a personalized curriculum and study plan.

WisdomPlan

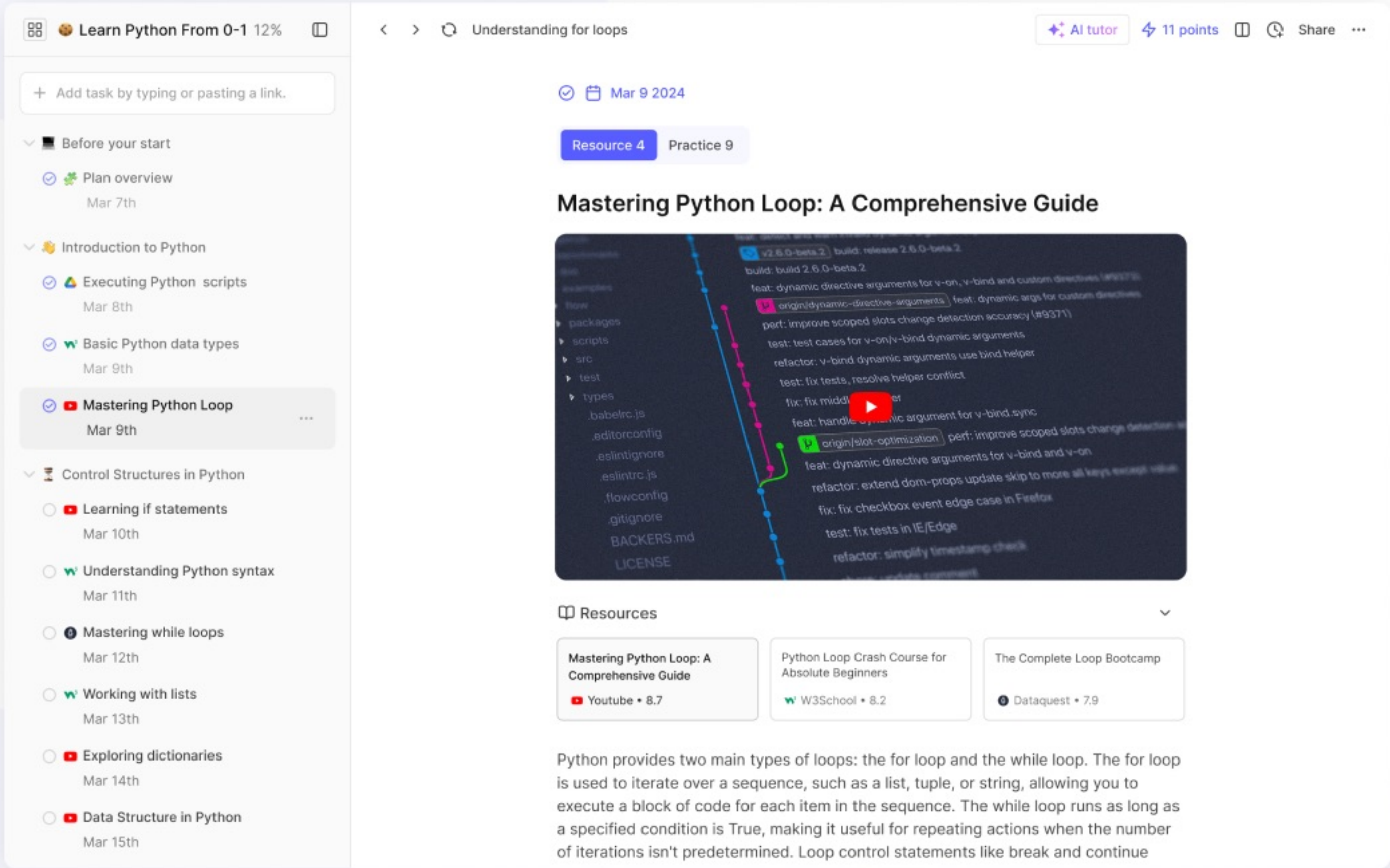
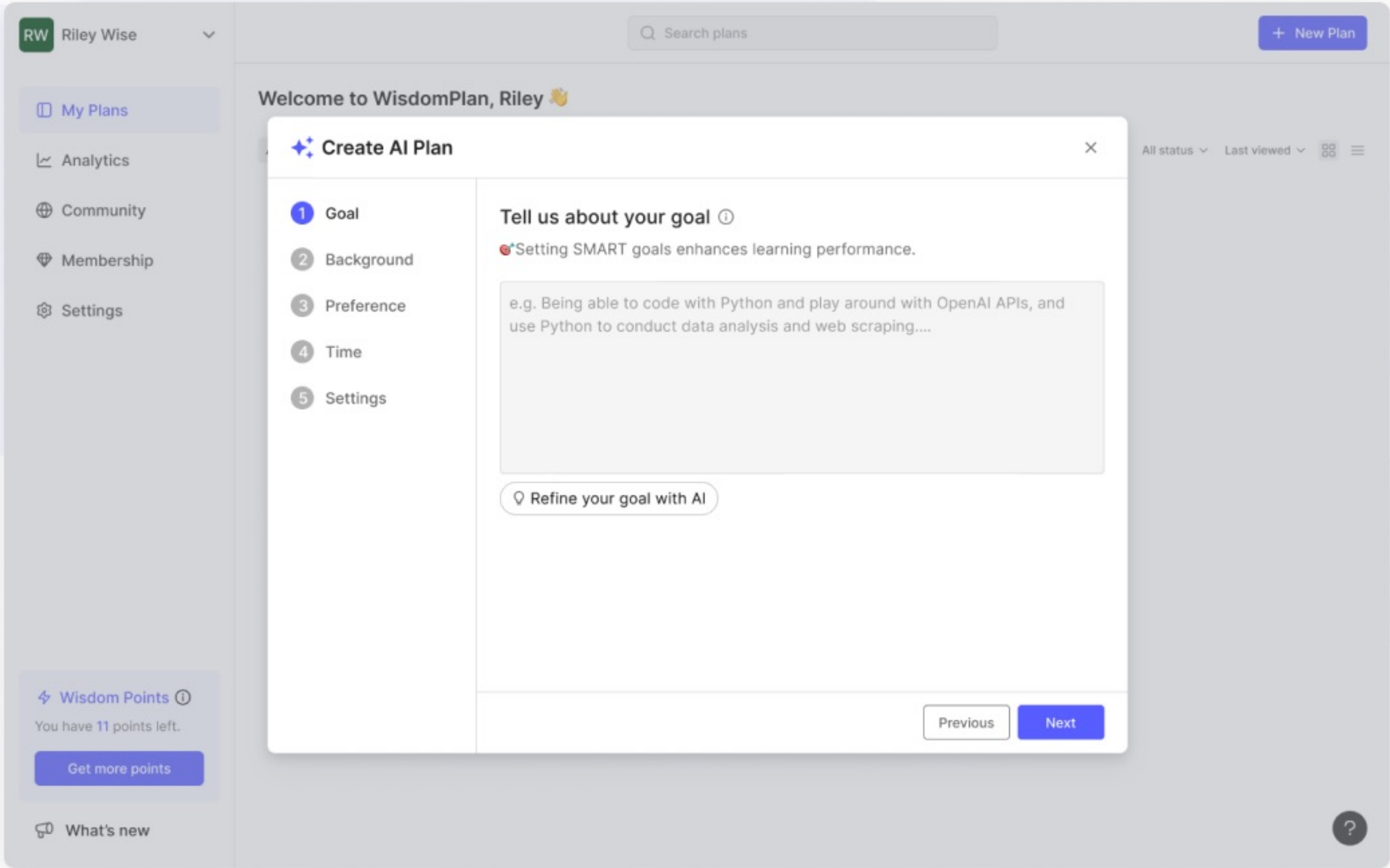



# Deeper Learning

## Take Notes and Complete Quizzes

WisdomPlan can use AI to help users summarize key points, organize their thoughts, and make their notes clearer and easier to understand.

Additionally, WisdomPlan can use AI to generate quizzes based on the content just learned, combining learning with testing to help users comprehend and reinforce the knowledge points they've recently acquired.

Learn Python From 0-1 12%

+ Add task by typing or pasting a link.

Before your start

Plan overview

Mar 7th

Introduction to Python

Executing Python scripts

Mar 8th

Basic Python data types

Mar 9th

Mastering Python Loop

Mar 9th

Control Structures in Python

Learning if statements

Mar 10th

Understanding Python syntax

Mar 11th

Mastering while loops

Mar 12th

Working with lists

Mar 13th

Exploring dictionaries

Mar 14th

Data Structure in Python

Mar 15th

Mastering Python Loop: A Comprehensive...

July 23 2023

Resource 4

Practice 9

Mastering Python Loop: A Comprehensive Guide



Resources

Mastering Python Loop: A Comprehen...

Youtube • 8.7

Complete hands-on projects and exercise...

W3School • 8.2

The Complete Loop Bootcamp

Dataquest • 7.9

Python provides two main types of loops: the for loop and the while loop. The for loop is used to iterate over a sequence, such as a list, tuple, or string, for each item in the sequence. The while loop runs as long as a specified condition is True, making it useful for repeating actions when the number of iterations isn't predetermined. Loop control statements like break and continue allow for more control by either exiting the loop early or skipping to the next iteration. You can also use else with loops to execute a block of code when the loop finishes normally. Nested loops are loops within loops, which are useful for working with multidimensional data structures. Overall, loops are essential for automating repetitive tasks in Python, making code more efficient and concise.

AI tutor

Clear chat

\_\_\_\_\_ statements are used in Python to check multiple conditions in a sequence.

Fill the Blank

A

elif

B

for

C

while

D

def

Hint

Continue

Ask me anything...

AI tutor can make mistakes. Double-check its responses.

Notes

Quizzes



# AI Tutoring Answer and Solve Your Questions

WisdomPlan's AI tutor, having undergone fine-tuning on the course content, can better understand and deliver information relevant to the current course. It is capable of answering users' questions and providing guidance related to the subject matter.

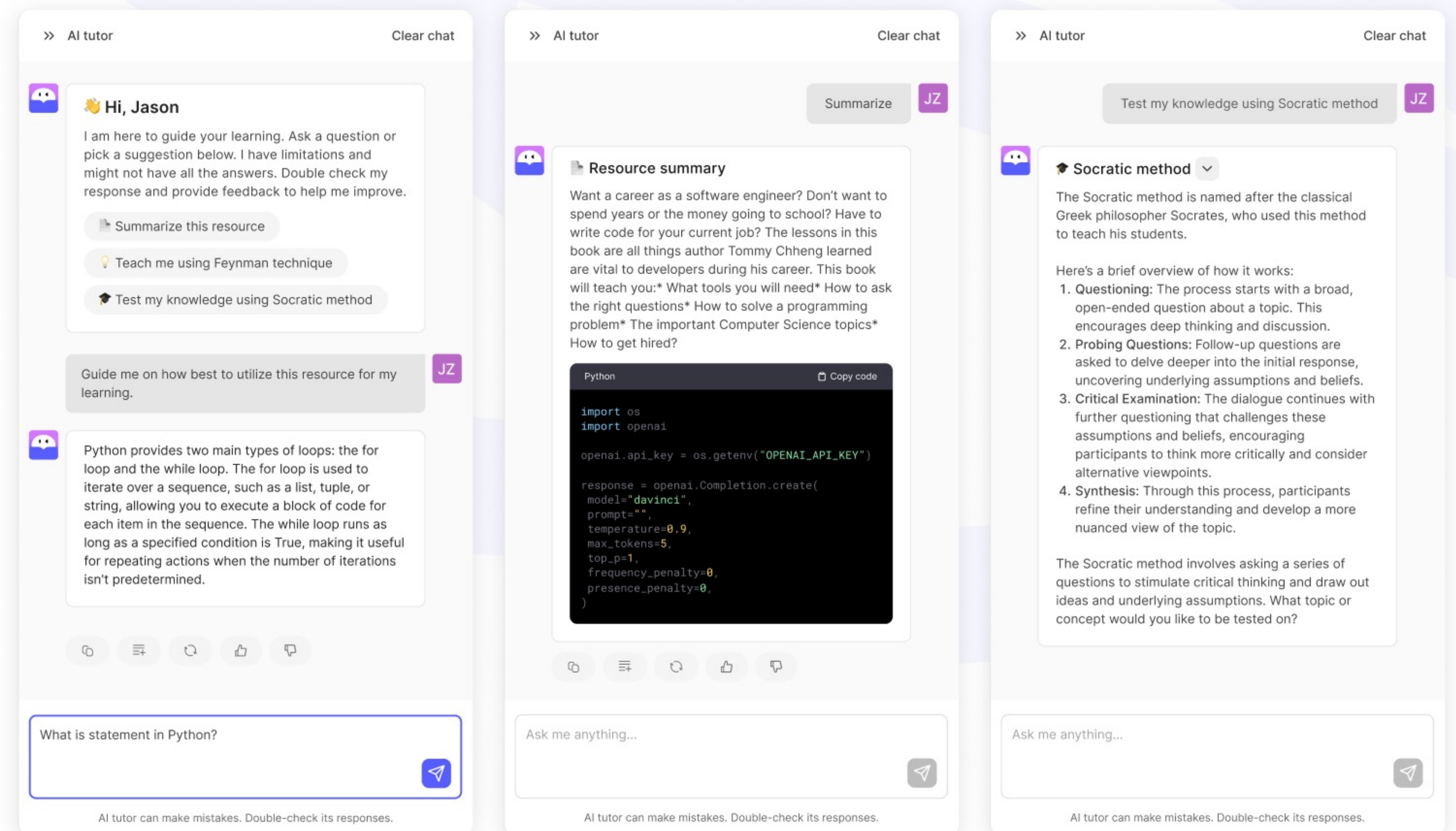



# Achievement

## Earn a Certificate

Positive feedback is also an essential part of the learning process. Upon completing a plan, users receive a corresponding Certificate, which they can share with other users. This further provides positive reinforcement to the users.

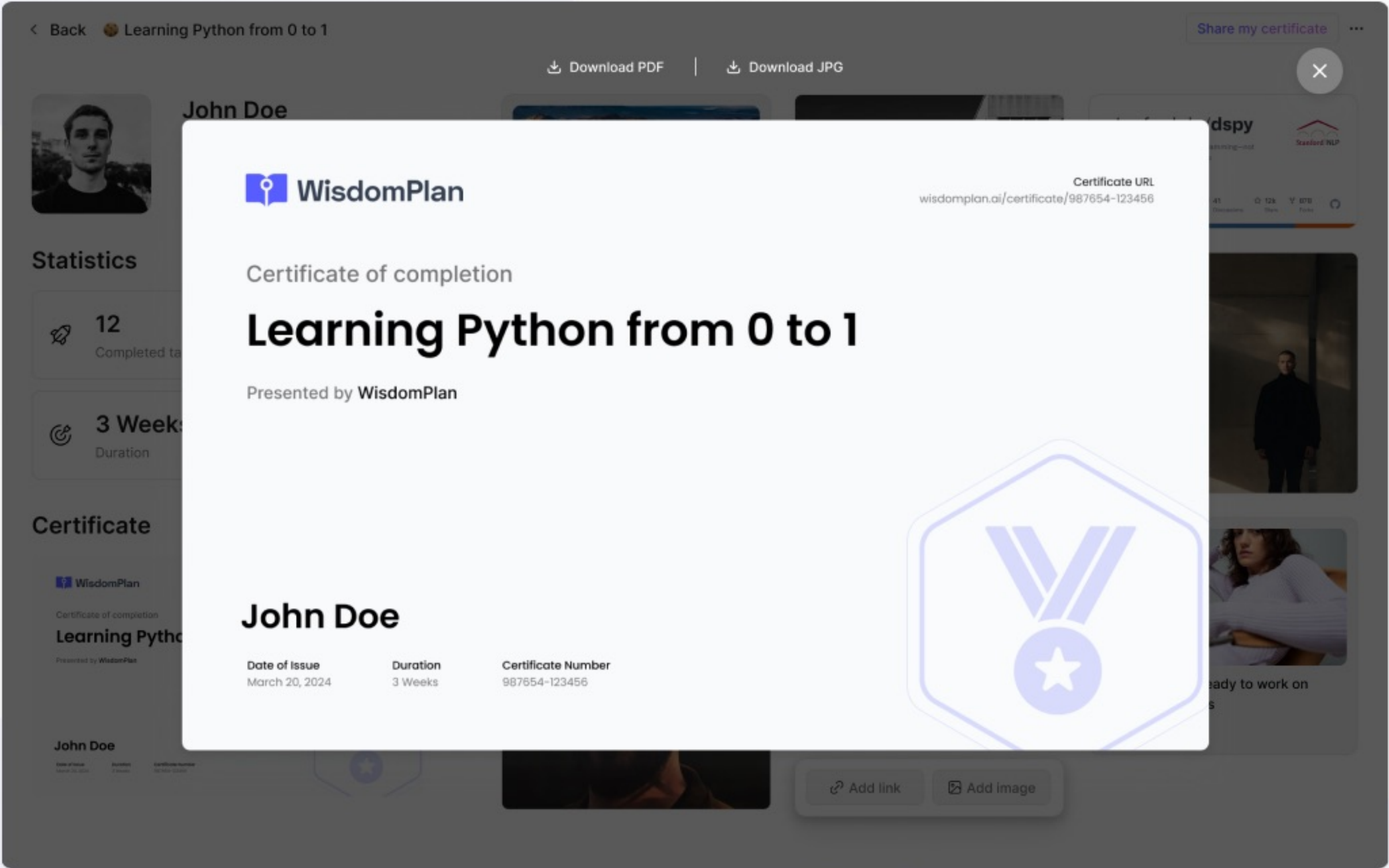
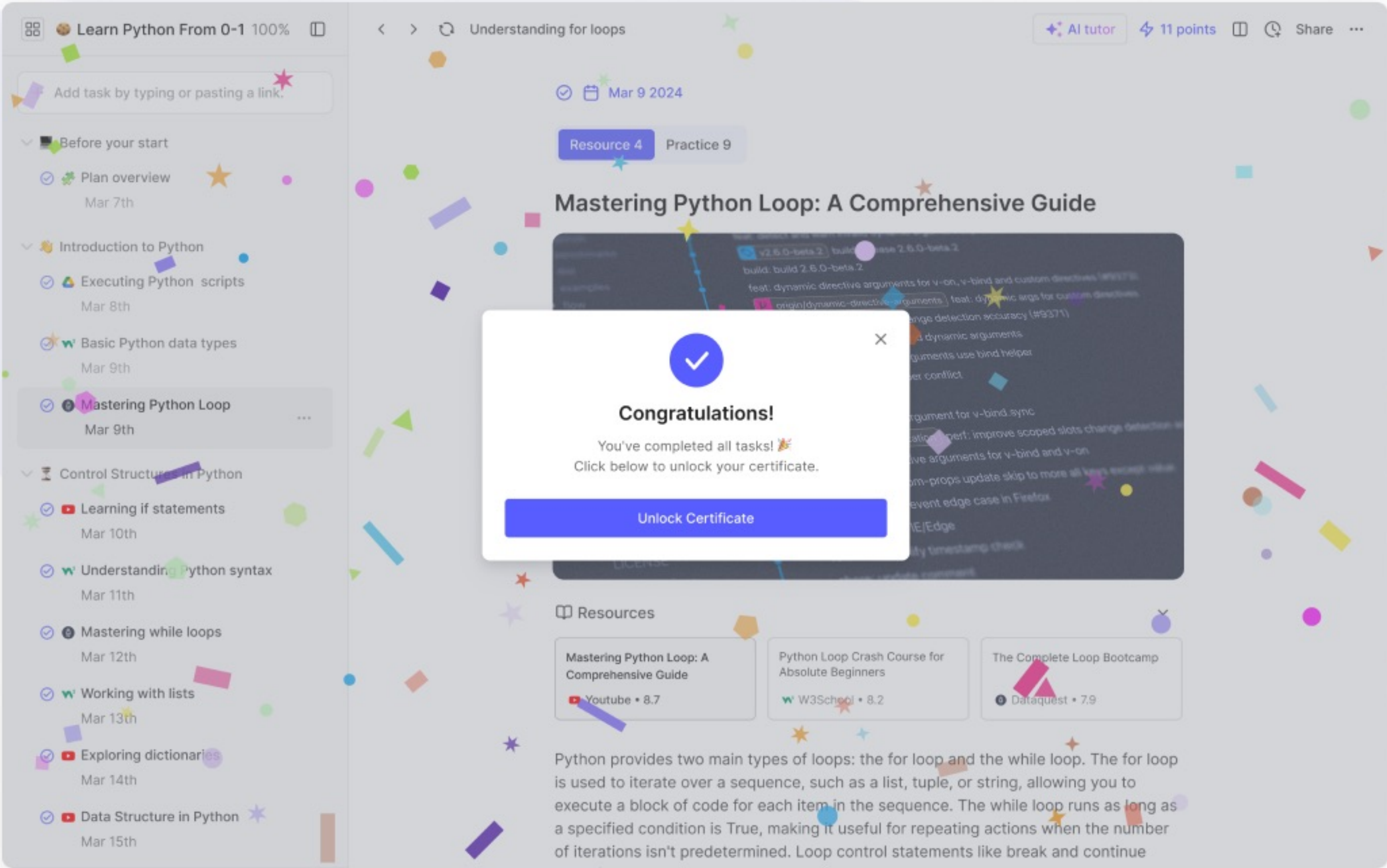



# Peer Learning

## Share and Explore Your Plan with the Community

WisdomPlan aims to encourage self-learners to motivate each other and create a positive learning atmosphere. To this end, we have established a community for learners. Here, users can share their own plans as well as browse and learn from the plans of others.

