

# Mini Sonata

A Miniature Instruments Set

Design: Keyue Ni

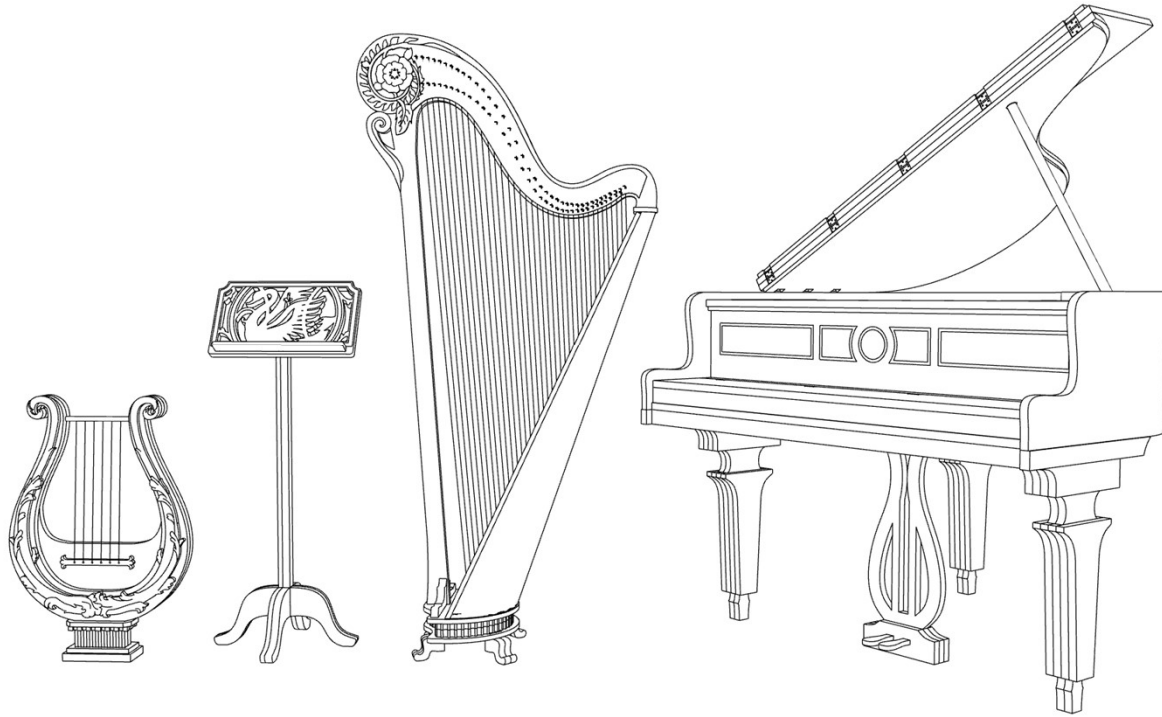

"Mini Sonata" is a captivating collection of four meticulously crafted miniature classical instruments: a lyre, a music stand, a harp, and a grand piano. Unlike typical 1:12 scale models, these stunning replicas are scaled at 1:4, offering an impressive level of detail and making them a striking addition to any home.

Crafted from high-quality laser-cut plywood, each "Mini Sonata" model is thoughtfully designed to faithfully recreate the elegant beauty of these iconic instruments while presenting an engaging and rewarding assembly challenge. Through the hands-on process of building these miniature masterpieces, individuals can experience the satisfaction of creation and cultivate a sense of calm and tranquility.

## How It Works:

Each "Mini Sonata" set includes precisely laser-cut wood boards and all necessary components for assembling the miniature instruments. Detailed instructions guide users through the construction process, allowing them to build their own unique models. Furthermore, 'Mini Sonata' encourages creativity and personalization. Customers are free to customize their models with modifications and apply their preferred paint colors, resulting in truly one-of-a-kind creations.

## Inspiration & Idea:

Beyond the direct inspiration of classical instruments, 'Mini Sonata' draws significant influence from the delicate art of paper cutting. The intricate laser-cutting techniques employed, coupled with the meticulous layering of components, echo the intricate beauty and dimensionality found in traditional paper cut artworks.



Paper Cutting Art (Hari and Deepti)

## Innovation:

"Mini Sonata" pioneers a novel approach to miniature model creation, leveraging the unique properties of laser-cut plywood. By meticulously stacking and assembling intricate layers, it achieves an unprecedented level of detail and realism in replicating the elegant curves and intricate details of classical instruments. The unconventional 1:4 scale expands the versatility of these miniature models beyond traditional collector's items. Their substantial size allows them to seamlessly integrate into home decor as unique and conversation-starting centerpieces.

## The Innovative Structures:

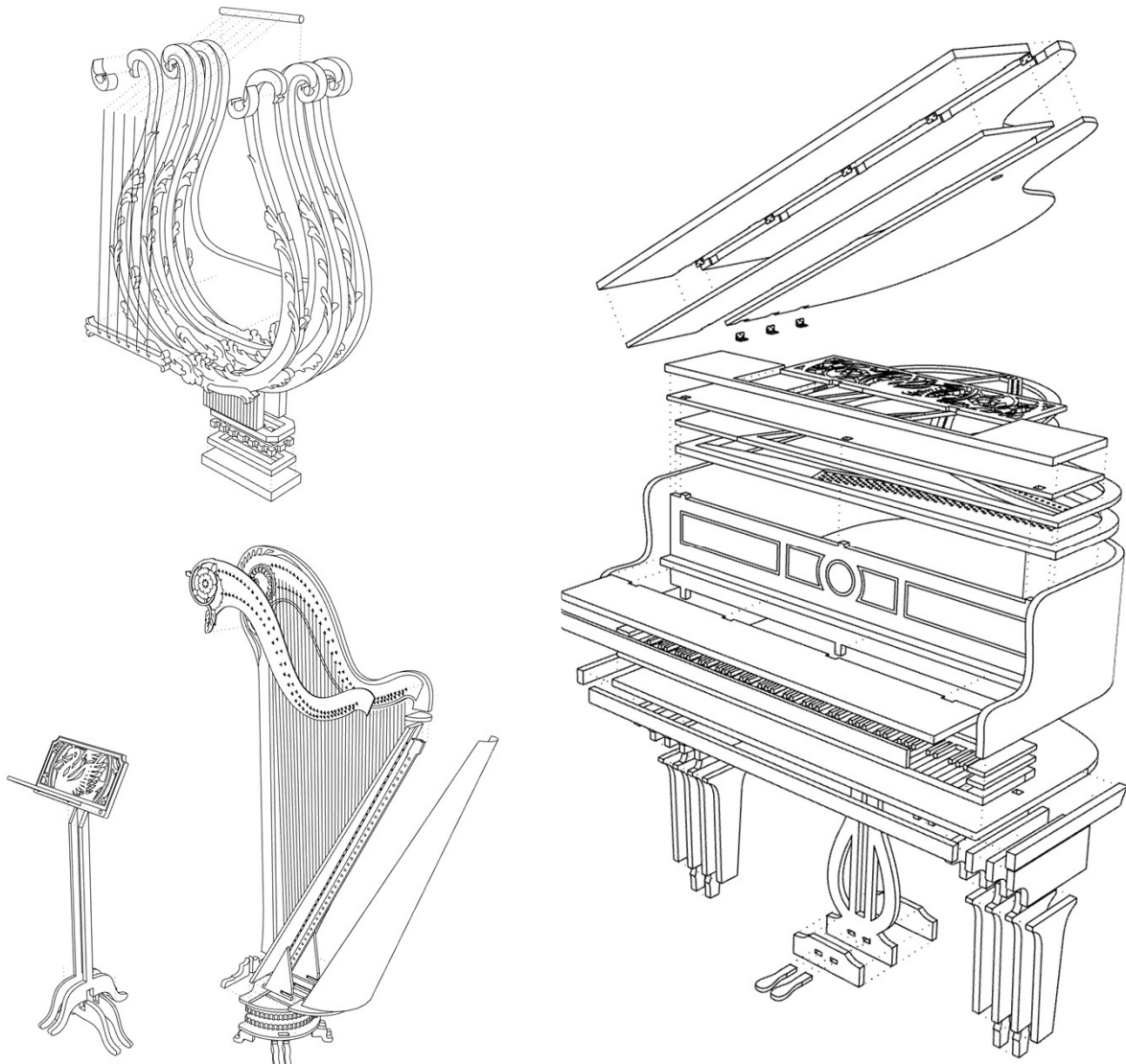

## **Aesthetics:**

Whether left in its natural wood tones or adorned with custom paint finishes, "Mini Sonata" presents a captivating aesthetic. The collection seamlessly blends contemporary design sensibilities with timeless elements of classical artistry, resulting in a timeless and versatile decorative piece that complements a wide range of interior styles.

## **The Samples of Built Models:**



## **Sustainability:**

"Mini Sonata" embraces a commitment to sustainability by prioritizing the use of plywood, a renewable and environmentally responsible material.

Sourced from responsibly managed forests, plywood boasts a low carbon footprint and is readily recyclable, minimizing the environmental impact of production and disposal.

## Marketplace:

Since its launch, "Mini Sonata" has garnered significant market recognition, achieving sales of nearly one thousand sets worldwide despite operating with limited investment. The innovative design enables cost-effective production within a lean manufacturing environment, minimizing the need for specialized facilities and reducing inventory backlog. Customer feedback has been delightfully positive, with many praising the model set's exquisite beauty and its user-friendly assembly process. Notably, "Mini Sonata" has captivated the attention of doll artists worldwide, who have enthusiastically incorporated the miniature instruments into their photography as focus point and highlights.

## Artistic Creation:

