

TECHNOLOGY



Quick fit

Provides instant and secure wiring and connections housed in an IP66-rated enclosure for robust protection against dust and water.



Smart fit

Enhance Tria Pole by incorporating advanced features, making it suitable for modern, connected environments.

Tria M



Qualicoat Seaside Class Powder Coat

Enhanced powder coating for aluminum, specifically formulated for superior durability and optimal performance in marine environments, lasting for over 10 years.

Tria M

Specification Sheet

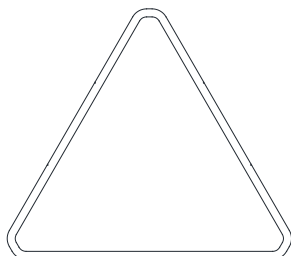

UL STD 1598 PENDING
IP55

POLE FEATURES

Design and Application

- Residential
- Urban park
- Marine

Mechanical details

- IK10
- Extruded aluminum body
- Double surface protected body with anodised base layer and powder coat top layer in Qualicoat Seaside standard
- Supplied with oil and water resistant cable

Electrical details

- 48VDC

Controls

- 0-10V
- DALI
- DMX

Integrated modability systems:

- Quick Fit
- Smart Fit

Sustainability

- Recyclable material
- Reparable

Links & Downloads

- Pole installation manual
- CAD file

Tria M

ORDERING INFORMATION

MODEL	
TRM	
HEIGHT	
40	• 40 - 4000mm
45	• 45 - 4500mm
50	• 50 - 5000mm
55	• 55 - 5500mm
60	• 60 - 6000mm
COLOR	
W	• W - RAL9003 Structure (Signal White)
S	• S - RAL7044 Structure (Silky Grey)
A	• A - RAL7016 Structure (Antracite Grey)
B	• B - RAL9005 Structure (Jet Black)
D	• D - RAL1015 Structure (Desert Sand)
G	• G - RAL6002 Structure (Leaf Green)
C	• C - Custom Structure Color
INSTALLATION	
U0	• U0 - Utility Vault
C0	• C0 - Concrete Anchor



Tria M

MANDATORY ACCESSORIES

Power supplies

PSU

[LINK](#)

- [List of available power supplies](#)

Installation options

INSTALLATION

C0

- C0 - Concrete Anchor

U0

- U0 - Utility Vault

U1

- U1 - Utility Vault with PS 240W

U2

- U2 - Utility Vault with PS 375W

C1

- C1 - Concrete Anchor 240W

C2

- C2 - Concrete Anchor 375W

OPTIONAL ACCESSORIES

Various

VARIOUS

TRMPC

- TRMPC - Pole Cover

FB

- FB - Fuse Box

S

- S - Sensors

ST

- ST - Static Sinage

EB

- EB - Expression backlight

ZS

- ZS - Zhaga Socket

C

- C - Connectors

RT

- RT - Cover removal tool

Consult you regional sales representative for further deatails

Tria M

INSTALLATION DETAILS

Pole height

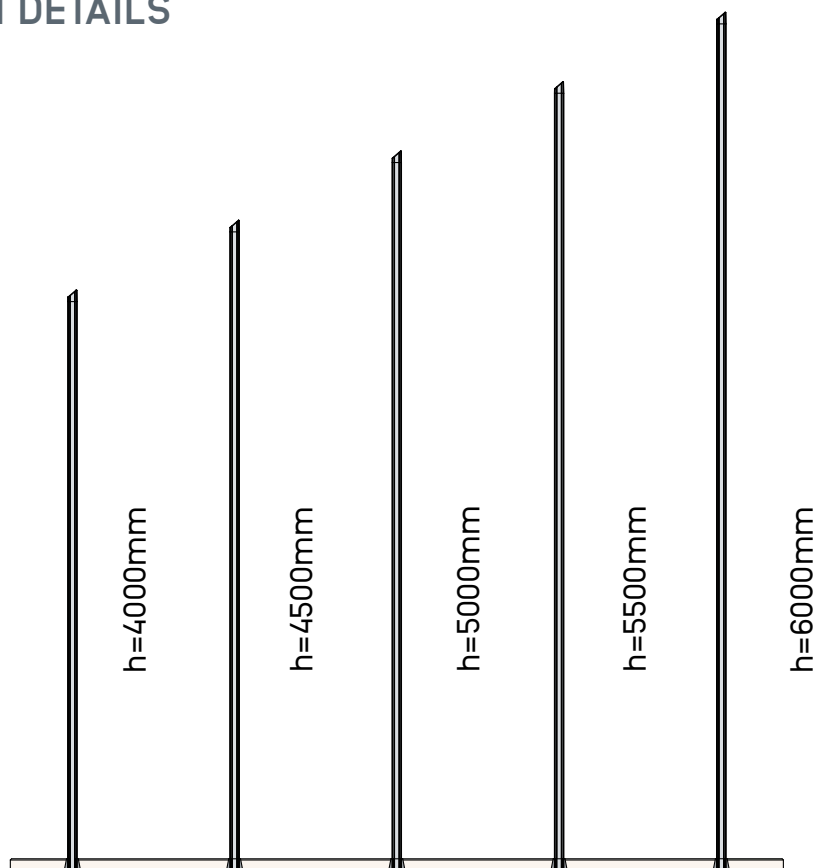

Wind zone 1
max. 6m

Wind zone 2
max. 5m

Wind zone 3
max. 4m

Profile details

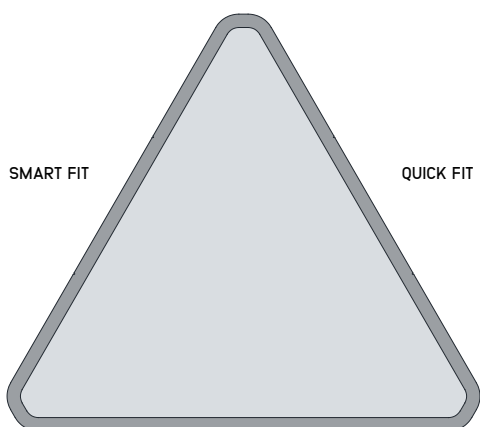

PREINSTALLED
POER CABLE 48VDC

IP-rated tracklight functionality is provided, ensuring reliable performance in demanding environments. Fixtures can be repositioned along the vertical profiles as needed, offering flexibility during and after installation. The profile is protected against tampering, and full system modularity is preserved even when the site installation is still in progress.

Tria M

INSTALLATION DETAILS

Concrete Anchor

Standard pole system installation on a concrete foundation, providing reliable and long-lasting stability, even in demanding conditions. With this anchoring method, the power supply needs to be placed remotely

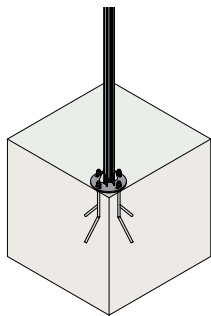

Utility Vault

The Utility Vault serves as a pre-installed access point for pole-mounted installations, functioning like an underground junction box. It enables simplified wiring by allowing the main power cable—running from the distribution cabinet—to terminate at the vault. From there, separate cables branch out to nearby luminaires. Depending on the luminaire type, each cable may serve one or multiple fixtures. LED transformers are housed directly within the Tria pole structure, streamlining installation and maintenance

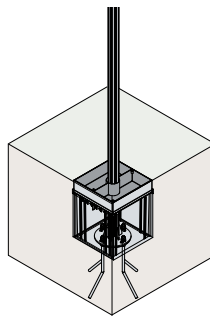

Tria M

QUICK FIT INSTALLATION

Step 1

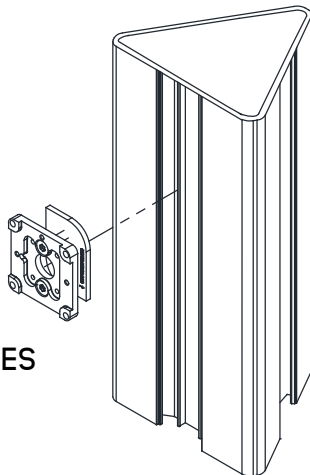

PARALLEL SURFACES
GOING IN

Step 2

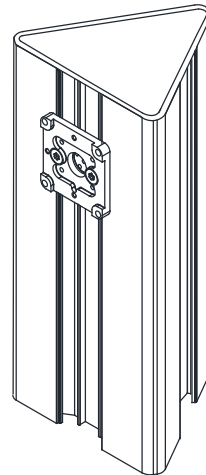

Step 3

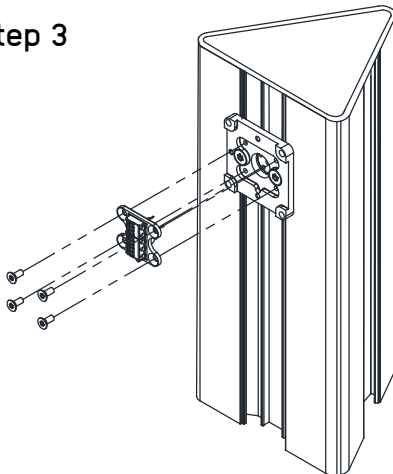

Step 4

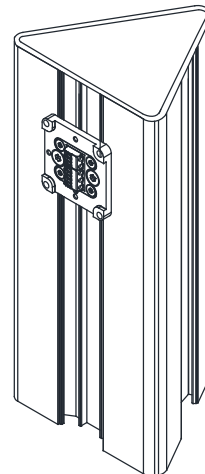

Quick Fit Installation

Designed for efficiency and flexibility, the system includes an IP66-rated instant wiring and connection method and is compatible with control protocols. Its streamlined installation process ensures quick deployment, while secure connections enhance reliability. The modular design makes it easy to expand with additional fixtures or adjust fixture positions as needed.

Tria M

MANDATORY ACCESSORIES

Power Supply

A LED power supply, is an electrical device designed to control the power supplied to an LED or an array of LEDs. It plays a critical role in LED lighting systems as LEDs demand a specific type and level of electrical current or voltage for optimal operation. It's important to note whether a constant current or constant voltage LED power supply is required. The power supply should be installed in a dry and easily accessible area.

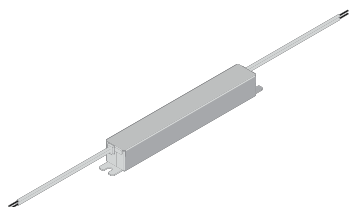

Tria M

OPTIONAL ACCESSORIES

Pole Cover

This replacement cover for an already installed pole system is designed to maintain both safety and functionality. It acts as a durable physical barrier between the pole's internal cabling system and the end user, ensuring reliable protection during operation and maintenance. In addition to its safety role, the cover can also accommodate communication-related components, making it suitable for integrated or smart pole applications.



Tria M

LIGHTING SOLUTIONS

TRION

Versatile architectural and landscape projector with Quick fit instant wire and connection method

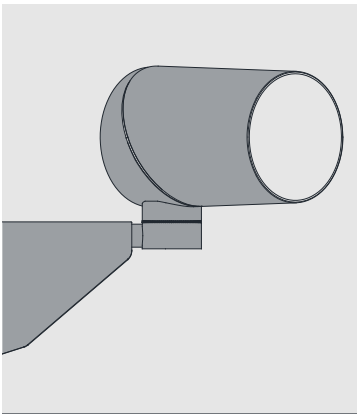

TRIFIX

Tria – pole or wall-mounted pathlight with integrated louvre and predefined installation angle, designed to ensure Dark Sky compliance and provide subtle, effective path illumination where more discreet lighting is required.

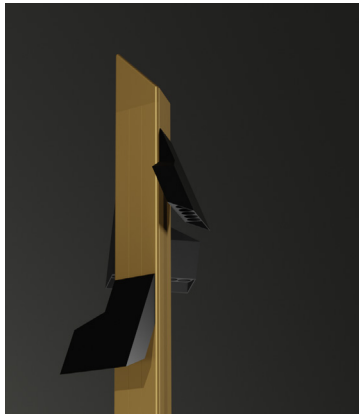

TRIST

Tria – pole-mounted streetlight with versatile optics, designed for effective and efficient illumination of functional areas in residential, urban and architectural environments.



TRACE

Designed to enhance and accentuate architectural surroundings, providing a continuous and seamless light effect. It serves as an effective tool for visual communication through light, guiding movement and defining space, while also supporting branding applications by creating recognizable and expressive lighting signatures.



Tria M

COMMUNICATION & BRANDING

Backlit Branding & Patterns

Illuminate logos, patterns, or custom textures for enhanced visibility, day and night.

Artistic & Cultural Displays

Incorporate artwork alongside branding to enhance local identity and aesthetics.



Tria M

CONNECTIVITY

Wi-Fi Integration

Enables seamless public internet access, enhancing digital connectivity in urban areas.



Surveillance & Security

Supports cameras and motion sensors for real-time monitoring and improved safety.



Environmental Sensors

Measures air quality, temperature, and other environmental factors, providing valuable urban data.

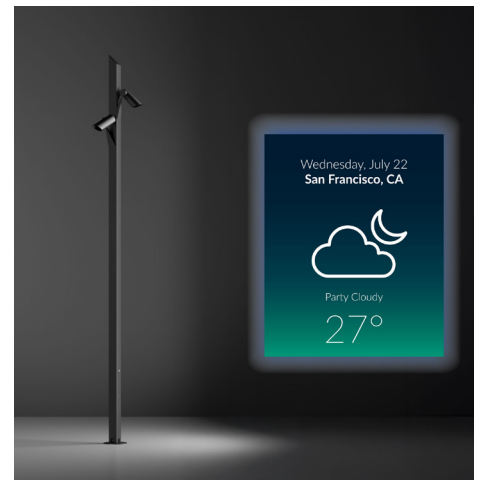

Motion sensor

The pole-mounted motion sensor detects movement, triggering outdoor lighting for enhanced security and energy efficiency. It ensures real-time responsiveness and optimal illumination.

